



**URBAN FIVE**  
RESIDENCES



**W** **Winstonfield**  
PROPERTY DEVELOPERS



Winstonfield is a property development company that offers unique lifestyle residential and commercial properties to individuals and organisations who seek to purchase or rent apartments, penthouses, houses and offices that meet an exquisite timeless design and style beyond the ordinary with a top notch quality.

---

The architectural and construction vision of Winstonfield, aims to redefine and upgrade the residential and commercial lifestyle status quo by presenting state-of-the-art prime property units, which masterfully blend the timeless classy and contemporary features that are implemented with an elegant and sophisticated manner.

Winstonfield's philosophy is to create and construct lifestyle residences in prime locations that will last through time. The firm cooperates with pioneer and leading architects and designers that settle only with the finest quality, providing freedom of flexibility and exclusivity.

---





---

## LIMASSOL, CYPRUS

**Cyprus** is an island in the eastern Mediterranean Sea renowned since ancient times for its mineral wealth, superb wines and produce, and natural beauty.

**Limassol** is the second largest city in Cyprus and the most southern of Europe. It is one of the most important tourism, trade and service providing centres. It is strategically located within the short distance between the airports, main port, Limassol Marina (the biggest one in Cyprus), seaside and the mountains.

---



**Limassol** has the most pristine beaches with crystal blue waters that extend for 17km and mild climate that attracts thousands of tourists all year round. There are plenty of sites and activities to enjoy that will satisfy every taste: A renowned Casino, exclusive Resorts, modern Skyscrapers, sporting events throughout the year, extreme sports, fun activities, cultural events, extensive shopping, spa and wellness beauty salons. You name it. Limassol has it all.

**Limassol** is the city that merges business and pleasure and it is full of pleasant surprises. It offers a variety of options according to your mood and preferences. By investing in Limassol real estate, you will inevitably gain on capital appreciation on your property due to upcoming trend of real estate prices going up and the popularity of Limassol itself rapidly raising.





**URBAN FIVE**  
RESIDENCES

---

## URBAN FIVE RESIDENCES

Discover this unique development which offers lavish and luxurious living at the eastern side of Limassol. A modern design that combines luxury, comfort and defines the ideal residence that will last through time.

Located in Moni area this development offers a quite and peaceful experience, whilst providing proximity to a plethora of amenities, hotels, cafes, and restaurants.

These luxurious residences are located only 7 minutes from Germasogeia Roundabout and about 2 minutes away from Parklane Hotel. The quick access to the motorway and sea front road of Limassol as well as the quiet and peaceful surroundings makes the project an ideal location for anyone.

---



# LUXURY TOWN VILLAS



03

The contemporary yet classy and luxury design style of Urban Five Residences by Winstonfield, integrates the sophisticated art style with the collection of five (5) superior villas that define an exquisite way of life.





Urban Five is a residential complex which will consist of 5 Town Villas with covered areas of 215 sq.m. The plots of the villas range with options of 450 sq.m. to 650 sq.m. with magnificent garden areas combining luxury and urban living. The project is developed with the highest Energy Efficiency standards.

A modern design that combines luxury, comfort and defines the ideal residence that will last through time. The epitome of luxury living and Energy A housing.





A chic courtyard and outdoor entertaining area are framed by large windows on both levels and offer alfresco living that's private and simple, echoes the modern flair found inside. Fine furnishings make this an attractive space as much for the interiors as for the furnishing.

With its smooth, sophisticated exterior and stocked stone wallboard, this home has a strong vertical presence while still blending in with its traditional counterpart. Using natural stone the project provides the natural aesthetics and durability.

---



## DISCOVER THE BEAUTY OF URBAN LIFESTYLE

Embrace modern architecture with minimal design. Immerse yourself in high-tech hubs buzzing with energy. Enjoy the unmatched natural beauty of tropical regions. Modern yet classy and luxurious, Urban Five by Winstonfield integrates the sophisticated art style with five (5) superior villas that define an exquisite lifestyle.

**MINIMALIST  
ARCHITECTURE**

**HOMES THAT  
INSPIRE CALM**



These luxury homes created by design pioneers help us to trace a recent history of minimalism in home design.

A modern, minimalist living space. The room features a white sofa with several pillows, a dining table with white chairs, and a glass-enclosed staircase with light wood treads. The space is bright and open, with large windows and a high ceiling. The floor is made of large, light-colored tiles. The overall aesthetic is clean and contemporary.

## CONTEMPORARY MINIMAL HOUSE WHERE IT`S ALL IN THE DETAILS

Taking inspiration from a focus on contemporary, modern, and minimal design, we have created stylish family houses with some amazing details that really take the spotlight.

Light streams through an unobstructed glass-enclosed stairway with light wood treads and an open rise connecting the main floor to the upper level.

With an open concept layout, the kitchen, dining and lounge areas have easy access to the courtyard.

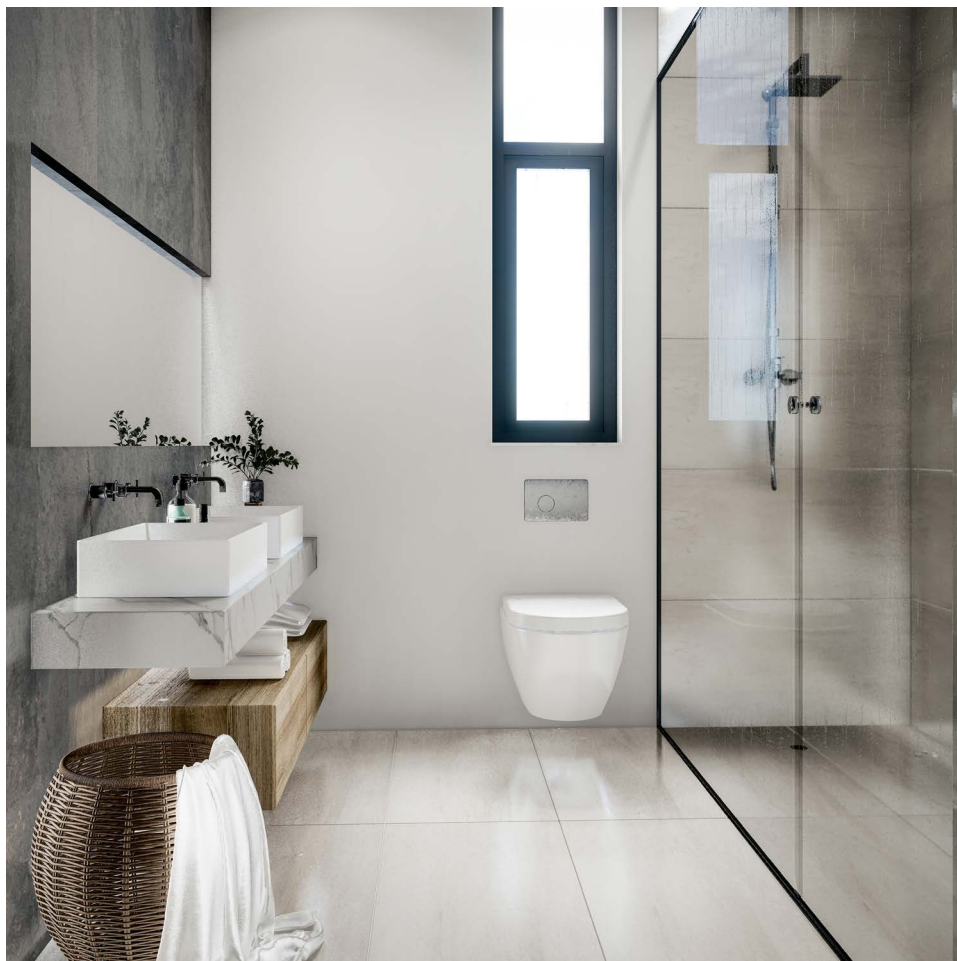

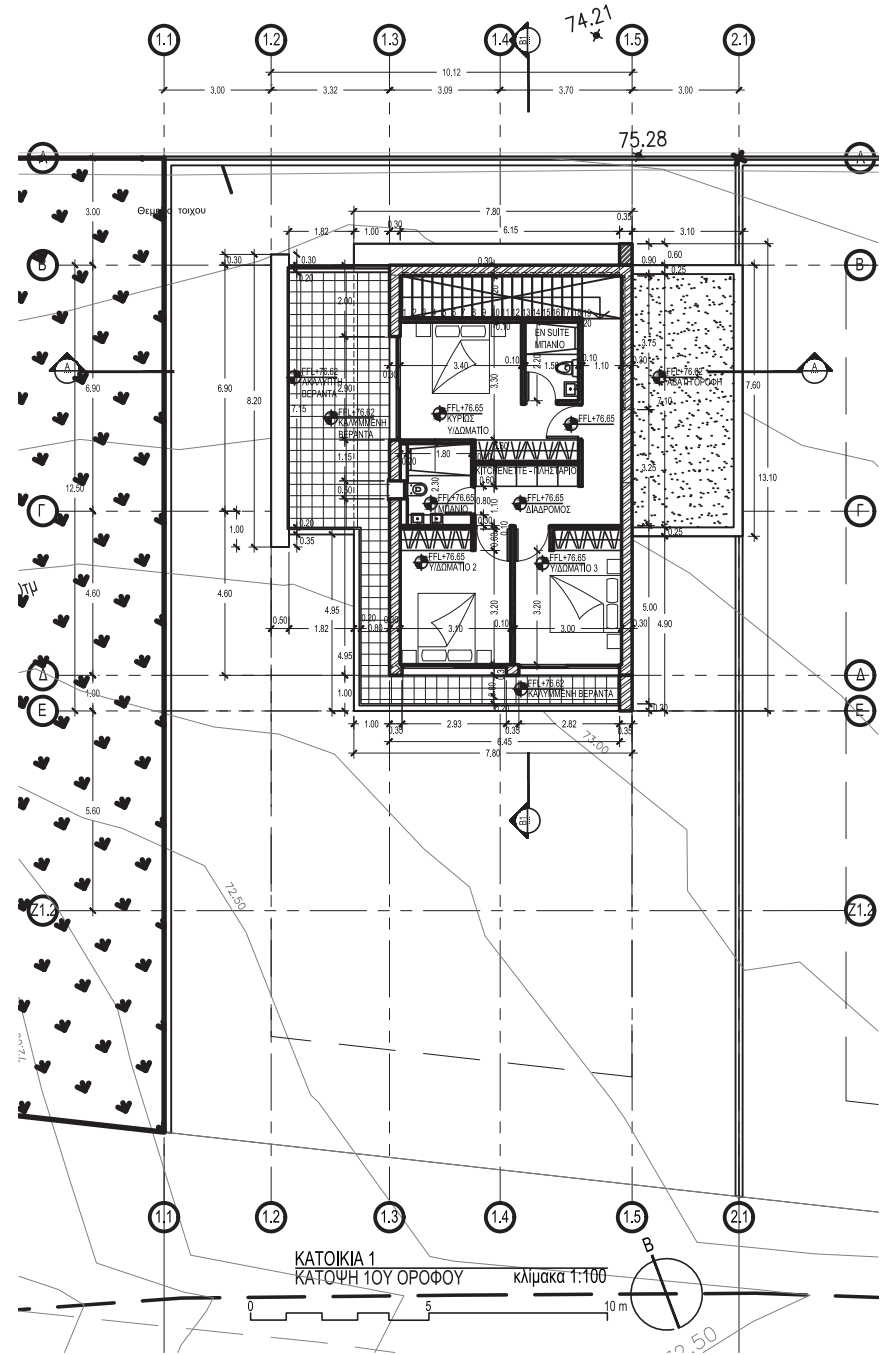
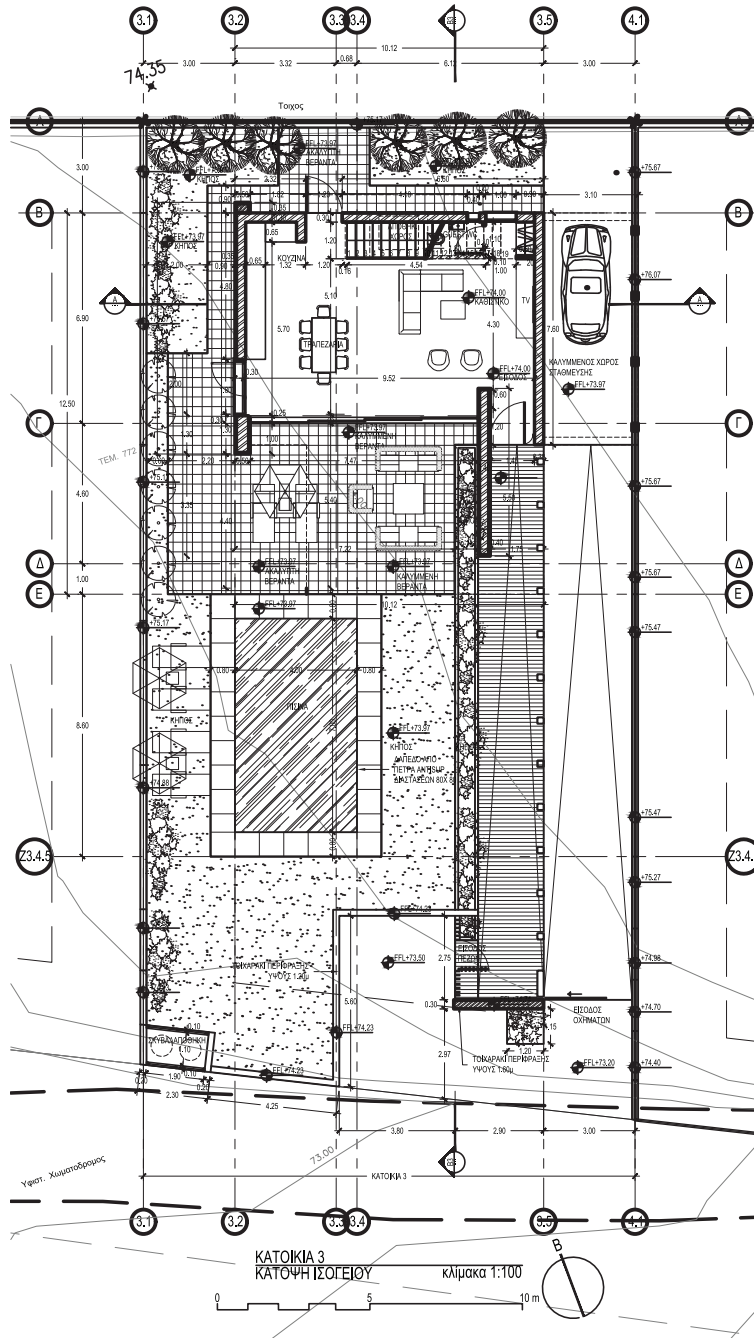



**URBAN FIVE**  
RESIDENCES

*by*



[www.winstonfield.com](http://www.winstonfield.com)

[info@winstonfield.com](mailto:info@winstonfield.com)

+357 700 3303

Arachovas 3, Limassol, 3096, Cyprus